

# ANTENNA MA4

## ▷ ANTENNA MA4 INSTALLATION

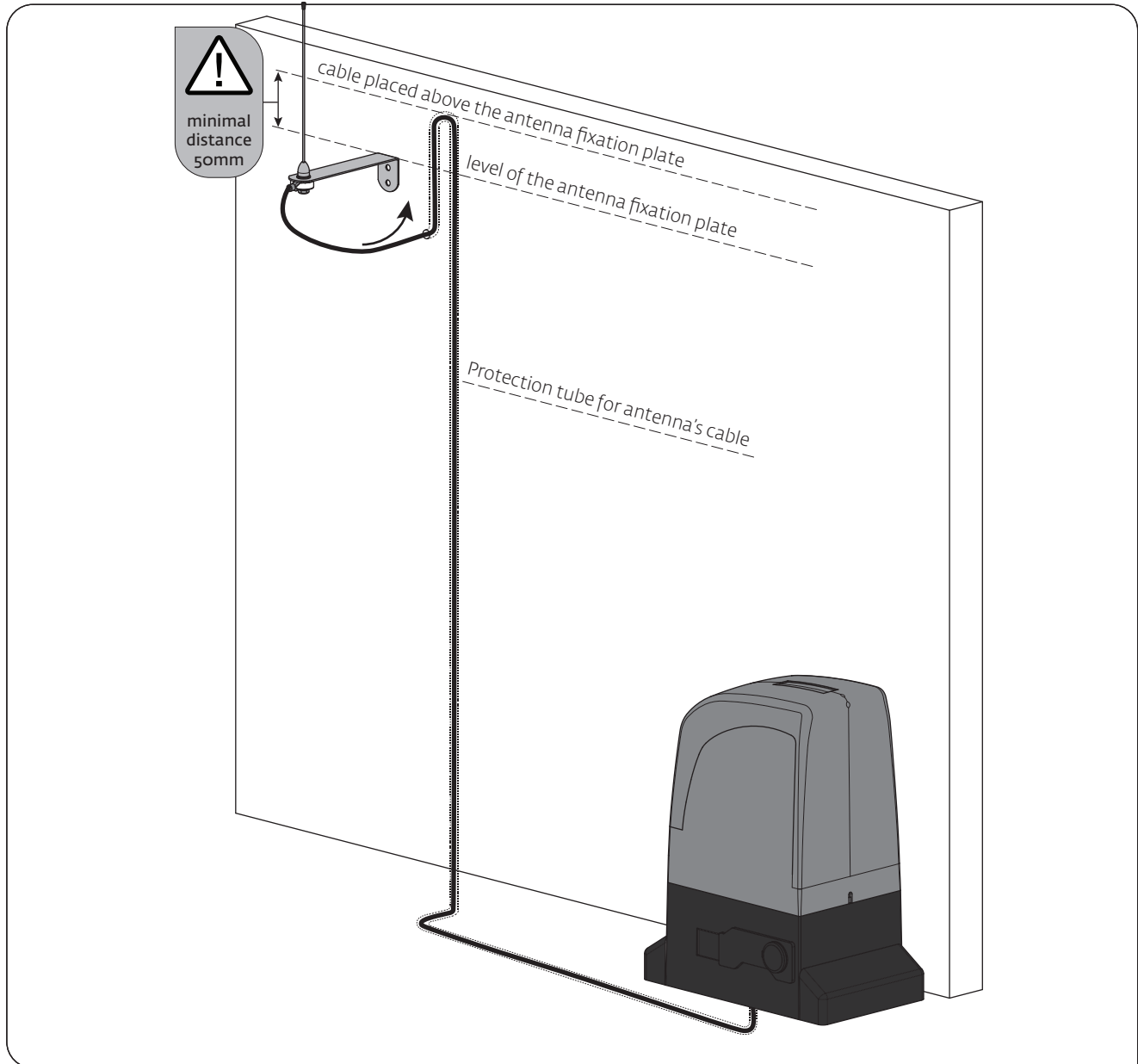

### Antenna installation:

Make the cable rise up at least 50mm above the fixation plate. After, descend the cable in a vertical position. To finalize, direct the cable horizontally to the motor.

Taking into account these indications, will ensure that the automatism is not damaged by humidity.

